



SMART LCD  
SOLDERING STATION 智能液晶烙铁焊台

---

## 产品特点

- 本产品具有声音报警与故障代码报警提示。
- 本产品内置散热片，给内部提供良好的温度环境工作。
- 本产品用途:电子元件引脚焊接、工业焊接、工作流水线焊接作业、实验教学、DIY及广大电子爱好者使用等。
- 焊台采用开关电源，具有高效节能、稳定温度、轻巧便携、多功能性和快速响应等优点，可以提高焊接效率和质量，适用于各种不同的焊接需求。

## 包装清单

焊台主机	烙铁手柄	烙铁发热芯	烙铁休眠架	电源线	高温吸水海绵	香蕉头休眠线	说明书
1台	1柄	1条	1个	1条	1块	1条	1本

---

---

## 安装步骤

### 1 手柄安装

安装时对着手柄接口插入，“达”一声即可安装成功。

### 2 发热芯拆卸与安装

拆下发热芯:可以拿镊子轻轻拔出。

插回发热芯:用手或镊子把发热芯放到手柄内部，发热芯头插入手柄安装到位即可工作。

### 3 香蕉头休眠线安装

休眠线的香蕉头对准主机的香蕉座插入，即可完成烙铁放置休眠。

## 注意事项

**为避免损坏焊台及保持作业环境安全,应遵守下列事项:**

- 切勿使用烙铁进行焊接以外的工作。
  - 切勿将烙铁敲击工作台以清除焊剂残余,此举可能严重损坏发热体及手柄。
  - 切勿擅自改装焊台内部结构。
  - 切勿弄湿焊台或手湿时不能使用焊台。
  - 焊台使用时,烙铁头部会有烟雾属正常现象,作业环境应有良好通风设施。
  - 使用焊台时,不可作任何可能伤害身体或损坏机器的变动。
  - 不要让异物挡住散热风扇进风口与出风口。
-

---

## 操作指南

初次使用焊台,烙铁需要上锡处理,以延长烙铁头使用寿命。

### 上锡步骤:

01. 将开关处于关闭状态,插上烙铁手柄。
02. 插上电源,保证电源有良好的接地。
03. 将高温吸水海绵吸满水放于锡渣托盘内。
04. 打开焊台电源开关,调节焊台面板的“按键“使温度调至300-360度之间。
05. 等待加热恒温.等待面板温度显示稳定后方可进行下一步。
06. 将锡线靠近烙铁头,使其熔化,并均匀的涂在烙铁头焊接部位。

### 维护与保养:

- 当烙铁头有污垢,请在高温吸水海绵上擦拭干净或者在锡渣硅胶球上擦拭。
  - 当烙铁头部都有一层锡包住时,此时可调到合适温度正常工作。
  - 结束工作时,把手柄放回烙铁座上,再关机切断电源。
  - 烙铁使用时,焊台温度在含铅焊接时,温度应在330-360°C之间合适无铅焊接时应在340-380度之间较为合适。
  - 焊接时,尽量使用低熔点的焊锡丝,这样能有效延长烙铁头使用寿命。
  - 本焊台在出厂时已做温度校正,在使用一段时间后,烙铁头氧化会对温度造成偏差,如有需要,可用温度计进行温度校准。
-

---

## 功能说明

### 温度调节:

- 通过主机或手柄上的“▲▼”键调节所需温度，单击为“5度”的步进调节。
- 长按为持续步进快速调节。步进值可设置。

### 记忆通道设置:

- 产品具有3个记忆通道选择，可满足不同工作需求。

### 调用记忆通道:

- 单击CH键，切换CH1、CH2、CH3记忆通道。
  - 修改记忆通道温度:通过“▲▼”键调节所需修改的温度，长按“CH键”保存当前温度到记忆通道里。
-

## 菜单设置

- 一：短按“SET键”进入菜单
- 二：短按“SET键”为确认按键
- 三：通过“▲▼键”调整移动
- 四：通过“CH1.CH2”调解数值变化

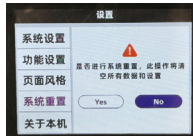
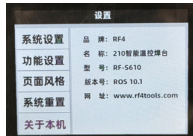
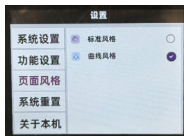
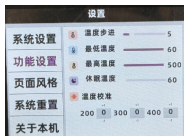

### 基础参数：

产品型号	输入电源	输出电压	功率	温度范围	恒温精度	接地电阻
RF-S610	90VAC-230VAC	12-24VDC	100W	200-500°C	±3°C	< 2mΩ

---

## 故障处理

“NO tools”:

发热芯没安装到位&发热芯损坏:更换发热芯。

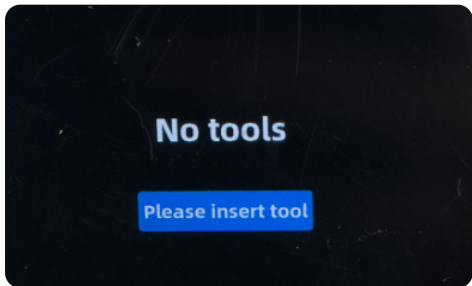

如无法自行解决故障问题请联系当地代理商或者是厂家技术支持。

---

---

## Product Features

- This product features sound alarm and fault code alarm prompts.
- This product is equipped with a heat sink to provide a favorable temperature environment for internal operation.
- The application of this product: electronic component pin welding, industrial welding, work line welding operations, experimental teaching, DIY and usage by a wide range of electronic enthusiasts, etc.
- The soldering station uses a switching power supply, which has the advantages of high efficiency, energy saving, stable temperature, lightweight and portable, multi-functionality and fast response. It can improve welding efficiency and quality, and is suitable for various different welding requirements.

## Packing List

- Power cord.....X1
  - Instruction manual.....X1
  - Soldering iron stand.....X1
  - Soldering iron handle.....X1
  - Soldering iron heating core.....X1
  - Soldering station main unit.....X1
  - Banana head dormancy line.....X1
  - High-temperature water-absorbing sponge.....X1
-

---

## Installation steps

### 1 Handle installation

During installation, insert it into the handle interface and it will be successfully installed with a "click" sound.

### 2 Disassembly and assembly of heating core

Remove the heating core: You can gently pull it out with tweezers.

Insert the heating core: Use your hand or tweezers to place the heating core inside the handle, and insert the heating core head into the handle until it is securely in place. Then it is ready to work.

### 3 Installation of banana head dormancy line

Align the banana head of the dormant cable with the banana socket of the main unit and insert it to complete the placement and dormancy of the soldering iron.

## Precautions

To avoid damaging the soldering station and maintain a safe working environment, the following precautions should be observed:

- Do not use a soldering iron for tasks other than soldering.
  - Never knock the soldering iron against the workbench to remove solder residue, as this may severely damage the heating element and the handle.
  - Do not modify the internal structure of the soldering station without authorization.
  - Do not wet the soldering station or use it when your hands are wet.
  - When using a soldering station, it is normal for smoke to be generated from the tip of the soldering iron. The working environment should be equipped with good ventilation facilities.
  - When using a soldering station, do not make any reckless movements that may harm your body or damage the machine.
  - Do not let foreign objects block the air inlet and outlet of the cooling fan.
-

---

## Operation Guide

When using the soldering station for the first time, the soldering iron needs to be coated with tin to extend the lifespan of the soldering iron tip

### Tin coating steps:

01. Set the switch to the off state and plug in the soldering iron handle.
02. Plug in the power supply and ensure it is properly grounded.
03. Fill the high-temperature water-absorbent sponge with water and place it in the tin slag tray.
04. Turn on the power switch of the soldering station and adjust the "button" on the soldering station panel to set the temperature between 300-360 degrees.
05. Wait for the temperature to stabilize. Proceed to the next step only after the panel temperature display stabilizes.
06. Bring the tin wire close to the tip of the soldering iron, allow it to melt, and evenly apply it to the soldering area of the tip.

### Maintenance and upkeep:

- When the tip of the soldering iron becomes dirty, please wipe it clean on a high-temperature absorbent sponge or wipe it on a solder slag silicone ball.
  - When the tip of the soldering iron is covered with a layer of tin, it can be adjusted to the appropriate temperature for normal operation.
  - When finished with work, place the handle back onto the soldering iron stand, then turn off the machine and disconnect the power supply.
  - When using a soldering iron, the temperature of the soldering station should be between 330-360°C for lead-containing soldering, and between 340-380°C for lead-free soldering.
  - When soldering, it is advisable to use solder wire with a low melting point, as this can effectively extend the lifespan of the soldering iron tip.
  - This soldering station has undergone temperature calibration before leaving the factory. After prolonged use, oxidation of the soldering iron tip may cause temperature deviations. If necessary, a temperature meter can be used for calibration.
-

---

## Functional Description

### Temperature regulation:

- Adjust the desired temperature using the "▲▼" keys on the console or controller. A single press adjusts by "5 degrees." Long press for continuous rapid step adjustment. The step value can be set.

### Memory channel settings:

- The product features three memory channel options to cater to various work requirements.

### Call memory channel:

- Click the CH button to switch between CH1, CH2, and CH3 memory channels.
  - Modify memory channel temperature: Use the "▲▼" keys to adjust the desired temperature, and press and hold the "CH" key to save the current temperature to the memory channel.
-

## menu settings

1. Short press the "SET" button to enter the menu.
2. Second: Short press the "SET" button to confirm.
3. Third: Adjust movement using the "▲▼ keys".
4. Fourth: Adjust the numerical value through "CH1.CH2".

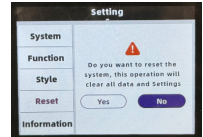
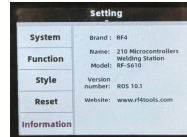
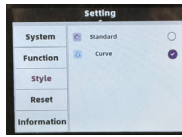
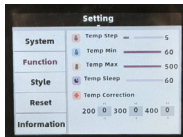
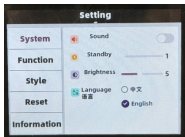

## Basic Parameters:

Basic Parameters	input power	output voltage	power	temperature range	Thermostatic accuracy	grounding resistance
RF-S610	90VAC-230VAC	12-24VDC	100W	200-500°C	±3°C	< 2mΩ

---

## Fault handling

### “NO tools“:

The heating core is not installed properly & the heating core is damaged: replace the heating core.

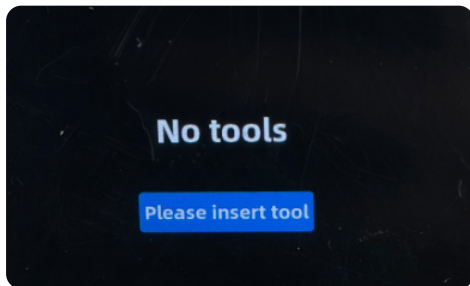

If you are unable to resolve the fault issue on your own, please contact your local agent or the manufacturer's technical support.

---

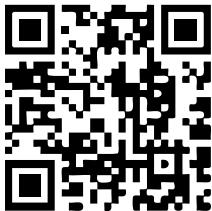

Scan the code to learn more

扫一扫 了解更多



## 广州市快速立电子科技有限公司

地址 广东省广州市荔湾区东漖北路470号盈昊大厦26楼  
电话 400-001-8044  
邮编 510370  
网址 <https://www.rf4tools.com>

## Guangzhou KSL Electronic Technology Co., LTD

ADD 26F, Yinghao Building, No. 470 Dongjiao North Liwan District,  
Guangzhou City, Guangdong Province, China  
TEL 400-001-8044  
POSTCODE 510370  
WEBSITE <https://www.rf4tools.com>

---